

CAYMAN BRAC 0.28 ACRE, CENTRAL LOCATION CORNER LAND LOT

Cayman Brac Central, Cayman Islands

PROPERTY DETAILS

Price: CI\$35,000	MLS#: 417812	Type: Land
Listing Type: Low Density Residential	Status: Pending/Conditional	Width: 164
Depth: 151	Built: 0	Acres: 0.2828

PROPERTY DESCRIPTION

Welcome to your haven in Cayman Brac. This 0.28-acre lot on Rock Ridge Ave, just off Capt Mabry Drive, is in a prime location. You'll have easy access to the airport, restaurants, and shops. This property is perfect for both homeowners and investors, with plenty of room to expand.

PROPERTY FEATURES

Views	Inland
Block	99A
Parcel	413
Zoning	Low Density residential
Road Frontage	57
Soil	Other

IMAGES

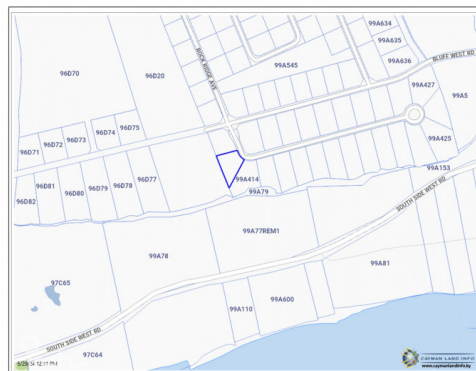

CIREBA MLS LDX feed courtesy of PROPERTY CAYMAN LTD

***Disclaimer:** The information contained herein has been furnished by the owner(s) and or their nominee and represented by them to be accurate. The listing company, agent and CIREBA MLS disclaims any liability or responsibility for any inaccuracies, errors or omissions in the represented information. The listing details herein are also courtesy of CIREBA (Cayman Islands Real Estate Brokers Association) MLS and/or via LDX (Listing Data Exchange) feed. All the information contained herein is subject to errors, omissions, price changes, prior sale or withdrawal, without notice and is at all times subject to verification by the purchaser(s).